

# NEW HOPE PLAZA

555 E. New Hope Road  
Goldsboro, NC 27534



*New Hope Plaza is located on New Hope Road near the intersection with Central Heights between Berkeley Boulevard and Eastern Wayne High School and is the grocery destination for northeast Goldsboro. The center is anchored by a 38,273 square foot Food Lion and an 8,000 square foot Family Dollar. Merchants seeking a highly visible, well located development will find New Hope Plaza an ideal site for commerce. In-line retail and outparcel opportunities are available.*



## TRAFFIC COUNT

- 11,000 vehicles per day per 2008 traffic survey

## DEMOGRAPHICS

Miles	Population	Households	Average household income
1 mile	5,777	2,246	\$71,654
3 mile	17,998	7,480	\$63,229
5 mile	43,766	54,106	\$54,106

*\*based on 2000 US Census of Population and Housing and 2010 estimates*

## LOCATION



Barnett Properties, LLC is a commercial real estate firm, specializing in the development, leasing, and management of retail properties. The company is based in Henderson, North Carolina, and has properties in North Carolina, Virginia and Georgia.

## CONTACT

Barnett Properties, LLC  
Steve Sartorio  
(919) 846-8708  
ssartorio@barnettpropertiesllc.com  
[www.barnettpropertiesllc.com](http://www.barnettpropertiesllc.com)

# NEW HOPE PLAZA

555 E. New Hope Road  
Goldsboro, NC 27534

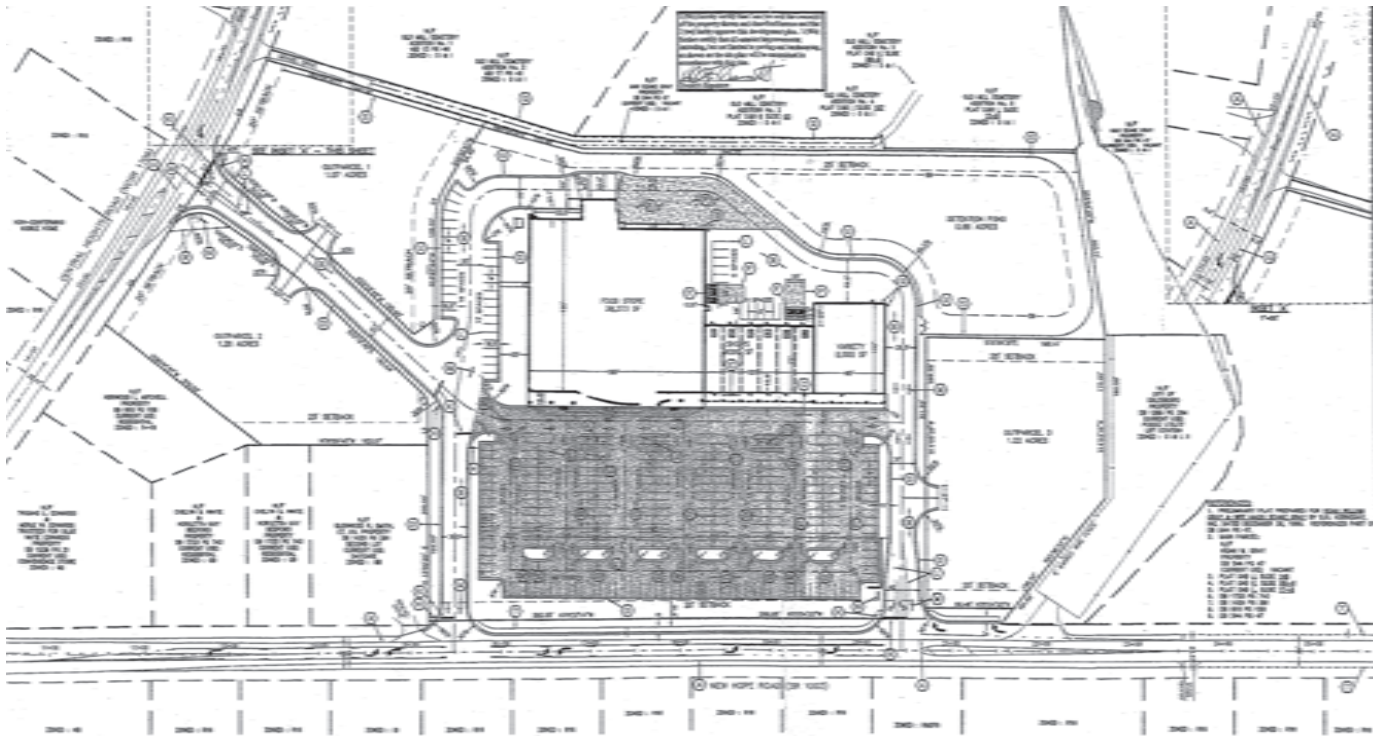

## TENANTS

SHOP	TENANT	SIZE
Anchor Tenant	Food Lion	38,273 sf
Anchor Tenant	Family Dollar	8,000 sf
Shop 1	China City	1,500 sf
Shop 2	Boutique	1,500 sf
Shop 3	Available	1,500 sf
Shop 4	Sweepstakes	1,500 sf
Shop 5 & 6	Available	3,000 sf

